

Q: What is the difference between fire resistive assemblies and fire protective assemblies?

A: Fire protective assemblies with glass are tested to UL 9/NFPA 257 and may only be used for applications up to and including 45 minutes without a temperature rise rating. Fire resistive assemblies tested to ASTM E119, UL 263 or NFPA 251 may be used for applications requiring up to and including 3 hours with a temperature rise rating.

Q: What is a fire resistive rated assembly?

A: A fire resistive assembly is an assembly that prevents or significantly retards the passage of excessive heat, hot gasses or flames up to and including 3 hours.

Q: Why are fire resistive assemblies required?

A: Fire resistive assemblies are required in Chapter 7 of the International Building Code.

Q: What glass can be used in the E119 frame assembly?

A: The E119 frame and glass are tested as an assembly. Vetrotech Contraflam glass is the only brand of glass that may be used.

Q: What types of E119 fire resistive products are available?

A: Frames, Doors and Interior Curtain Wall

Q: What fire ratings are available?

A: E119 Frames: 60, 90, 120, and 180 minute ratings
E119 Doors: 60 and 90 minute ratings.
E119 Interior Curtain Wall: 60 and 120 minute ratings

Q: Why is there a 120 minute or 2 hour rated assembly?

A: The building code considers the product to be a wall. One of the wall ratings is 2 hours.

Q: What options are available with E119 fire resistive products?

A: Level 3 bullet ratings for doors and frames. STC rated glass, corner and angled frames. Frames without vertical mullions using Contraflam Structure.

Q: Are installation instructions available?

A: Yes, installation instructions are available and can be found on the Pioneer website.

Q: How are fire resistive assemblies shipped?

A: Frames are shipped KD or welded and glazing is supplied loose for field installation. Door glazing is shipped loose for field installation as well.

Q: Are doors and frames primed or pre-finished?

A: Frames may be ordered primed or pre-finished.

Q: How is this product different from other common hollow metal fire rated door and frames with glazing?

A: E119 doors, frames and Vetrotech glass have a specific construction to produce a temperature rise rating of 250° as required by code and testing.

Q: Why can't standard hollow metal frames be used?

A: Standard hollow metal is tested to UL 9 and NFPA 257. Standard hollow metal does not have a temperature rise rating and does not meet E119 requirements.

Q: Can doors and frames be modified at a job site or a distributor's shop?

A: No, there are no secondary manufacturing procedures for this product.

Q: What doors may be used in an E119 transom/sidelight frame?

A: E119 Fire Resistive Doors and fire rated hollow metal or wood doors may be used, depending on the hourly rating of the frame.

Q: Do 2 hour doors need to be used in the 2 hour assembly?

A: No, the opening in an E119 frame is treated like the opening in a wall. A 90 minute door may be used in the 2 hour rated assembly.

Q: What hardware is available?

A: Exit devices, mortise and cylindrical locks, butt hinges, and surface mounted closers.

111 Kero Road
Carlstadt, NJ 07072
Phone: 201-933-1900
pioneerindustries.com

Experience a safer
and more open world

Pioneer is a brand associated with AADG, Inc., an ASSA ABLOY Group company. Copyright © 2019, AADG, Inc. All rights reserved. Reproduction in whole or in part without the express written permission of AADG, Inc. is prohibited.

CONTRAFLAM 60

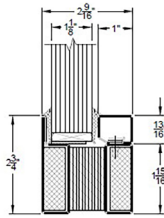

Fire Rating: 60 Minutes
 Jamb (System) Depth: 2 -9/16"
 Frame Face: 2-3/4" to 3-9/16"
 Frame Weight: 3.75 to 4.5 lbs. / Linear ft.
 Glass Thickness: Contraflam 60: 1-1/8"; Contraflam Structure 60 1-1/4"
 Maximum Visible Glass: Contraflam 60: Width 94-13/16", Height 94-13/16", not to exceed 3283 sq. in (Daylight Opening DLO)
 Contraflam Structure 60: Width 138-1/2" Height 138-1/2", not to exceed 7574 sq. in
 Level 3 Bullet Resistance
 STC 40

CONTRAFLAM 90

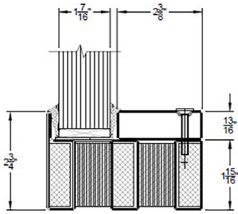

Fire Rating: 90 Minutes
 Jamb (System) Depth : 4 -5/16"
 Frame Face: 2-3/4" to 3-9/16"
 Weight: 6.33 to 6.63 lbs per linear ft.
 Glass Thickness: Contraflam 90: 1-7/16"
 Maximum Visible Glass: Contraflam 90: Width 94-13/16", Height 94-13/16", not to exceed 4435 sq. in (Daylight Opening DLO)
 Level 3 Bullet Resistance
 STC 45

CONTRAFLAM 120

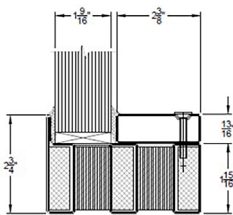

Fire Rating: 120 Minutes
 Jamb (System) Depth : 4 -5/16"
 Frame Face: 2-3/4" to 3-9/16"
 Weight: 6.33 to 6.63 lbs per linear ft.
 Glass Thickness: Contraflam 120: 1-9/16"; Contraflam Structure 120 2-1/16"
 Maximum Visible Glass: Contraflam 120: Width 94-5/8", Height 94-5/8", not to exceed 4435 sq. in (Daylight Opening DLO)
 Contraflam Structure 120: Width 126" Height 126" not to exceed 4536 sq. in
 Level 3 Bullet Resistance
 STC 46

CONTRAFLAM 180

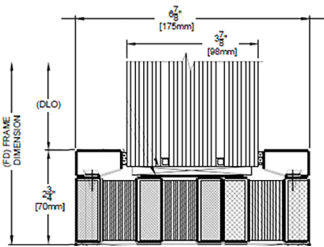

Fire Rating: 180 Minutes
 Jamb (System) Depth : 6-7/8" and 7-1/8"
 Frame Face: 2-3/4" to 3-9/16"
 Weight: 34.3 lbs per linear ft.
 Glass Thickness: Contraflam 180: 3-1/2";
 Maximum Visible Glass: Contraflam 180: Width 48", Height 48", not to exceed 2304 sq. in (Daylight Opening DLO)
 Level 3 Bullet Resistance
 STC 49

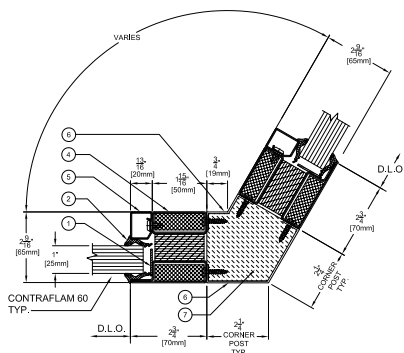

Corner and angled frames available